

W131-X30 Quick Installation Guide

Pre-installation Cautions



- Make sure the system is not turned on or connected to AC power.
- Always handle boards carefully. They can be extremely sensi-tive to electrostatic discharge (ESD). Hold boards only by their edges. After removing a board from its protective wrapper or from the system, place the board component side up on a grounded, static free surface. Use a conductive foam pad if available but not the board wrapper. Do not slide board over any surface.
- Risk of explosion if battery is replaced incorrectly or with an incorrect type. Replace the battery only with the same or equivalent type recommended by the manufacturer. Dispose of used batteries according to the manufacturer’s instructions.

Motherboard Components

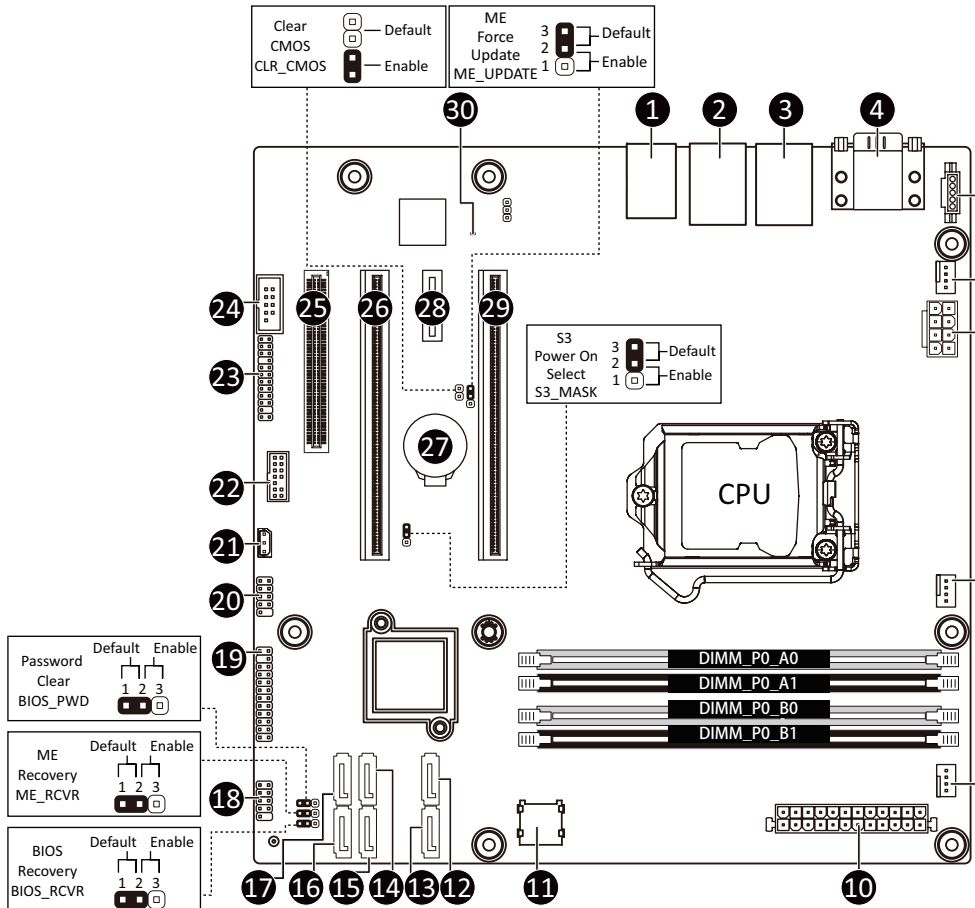

No.	Code	Description
1	MLAN	Server managemnt LAN port
2	USB2_LAN1	LAN port #1 (top) / USB 3.0 ports (bottom)
3	USB2_LAN2	LAN port #2 (top) / USB 3.0 ports (bottom)
4	COM1_VGA	Serial port (top) / VGA port (bottom)
5	PMBUS	PMBus connector
6	SYS_FAN1	System fan connector#1
7	P12V_AUX	8 pin power connector (for CPU)
8	CPU_FAN	CPU fan connector
9	SYS_FAN2	System fan connector#2
10	ATX1	24 pin main power connector
11	SD_CN	SD card connector
12	SATA_4	SATA 3 6Gb/s connector
13	SATA_5	SATA 3 6Gb/s connector
14	SATA_2	SATA 3 6Gb/s connector
15	SATA_3	SATA 3 6Gb/s connector
16	SATA_1	SATA 3 6Gb/s connector
17	SATA_0	SATA 3 6Gb/s connector
18	FP_2	Secondary front panel header
19	FP_1	Front panel header
20	F_USB2	USB 2.0 header
21	IPMB	IPMB connector
22	TPM	TPM connector
23	BP_1	HDD back plane board header
24	COM2	Serial port cable connector
25	PCIE_1	PCI Express x8 slot (running at x4)
26	PCIE_2	PCI Express x16 slot (running at x8)
27	BAT	Battery socket
28	PCIE_3	PCI Express x1 slot
29	PCIE_4	PCI Express x16 slot (running at x8)
30	LED_BMC1	BMC firmware readiness LED

System Cover

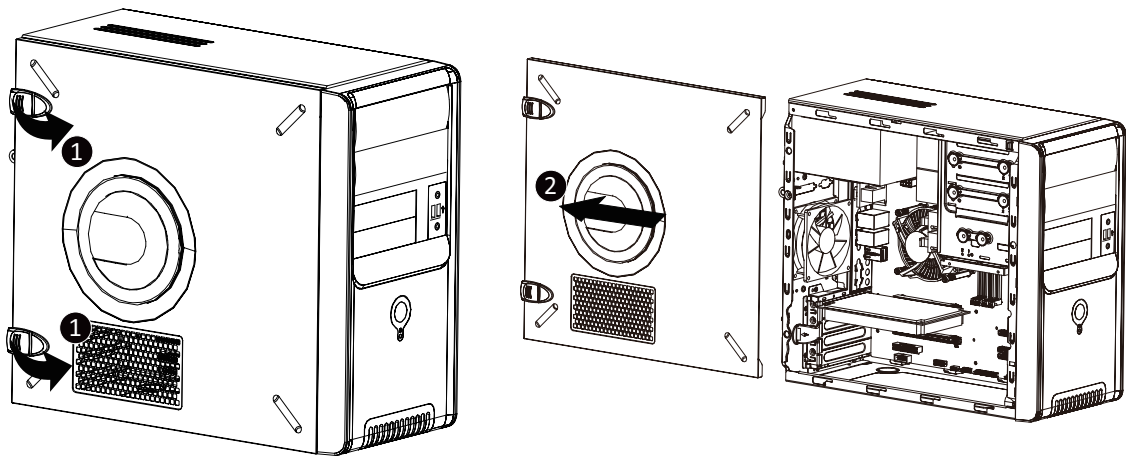

System Components

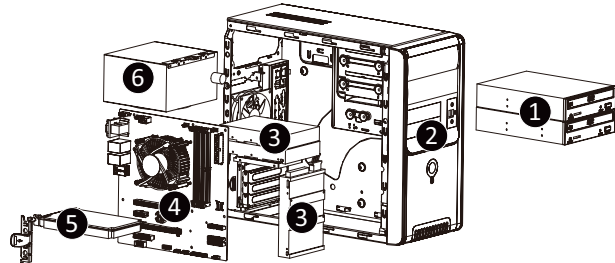

No.	Desription
1	Optical disc drive (Option)
2	Front bezel door
3	Hard Disk Drives
4	Motherboard
5	PCIe card bay
6	Power supply module

Front Bezel Door

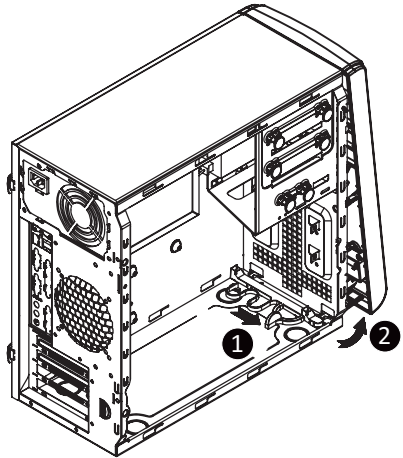

NOTE!
Remove side cover before removing the front bezel door

System Appearance

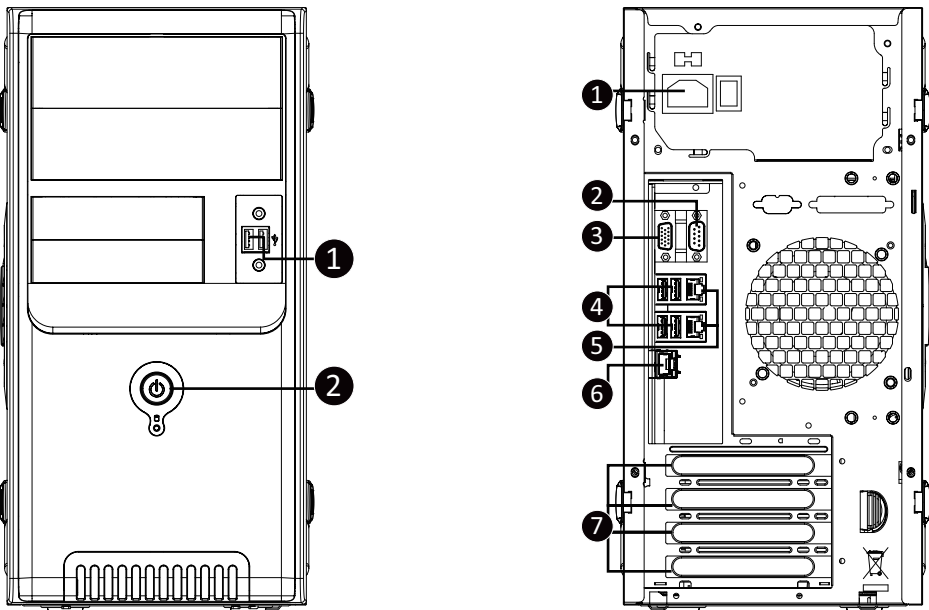

No.	Desription
1	USB 2.0 ports
2	Power button with LED

No.	Desription
1	Power supply module cord socket
2	Serial port
3	VGA port
4	USB 3.0 ports
5	GbE LAN ports
6	10/100/1000 Server management LAN port
7	PCIe card bay

PCI Express Card

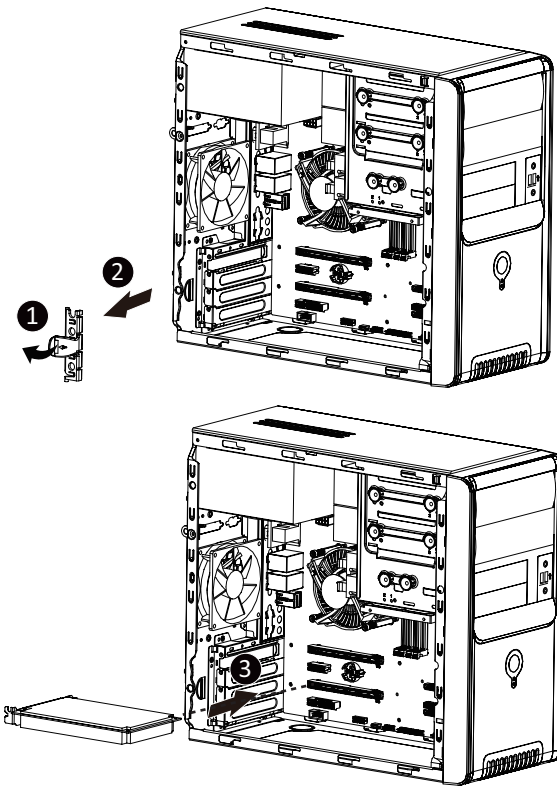

Installing CPU/ 安装 CPU

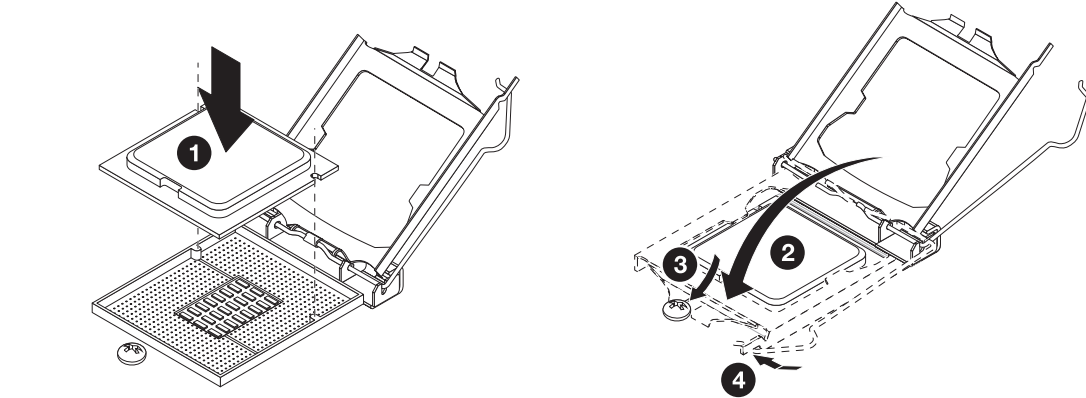

Memory Population Configuration/ 安装内存

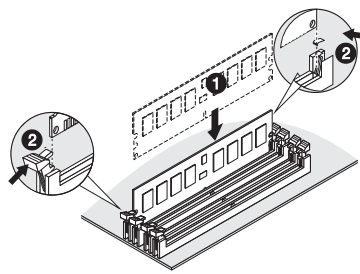

Type	Ranks Per DIMM and Data Width	Supported Voltage	Speed (MT/s), Slot Per Channel (SPC) and DIMM Per Channel (DPC)	
			2 Slot Per Channel	
			1DPC	2DPC
UDIMM Unbuffered DDR4 ECC	SR	1.2V	2133	2133
UDIMM Unbuffered DDR4 non-ECC	DR	1.2V	2133	2133

- All channels in system run at the fastest common frequency.
- Mixing ECC and non-ECC UDIMMs anywhere on the platform is not supported.
- 1 and 2 DPC is supported at 2133MHz.
- 所有通道模式以最快的频率速度运行。
- 此主板不支持ECC与非ECC内存模组混合使用。
- 1与2 DPC 均支持2133MHz速度。

Optical Disc Drive

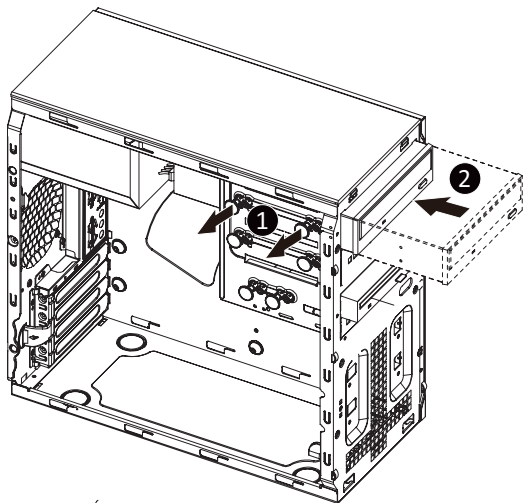

Power Supply

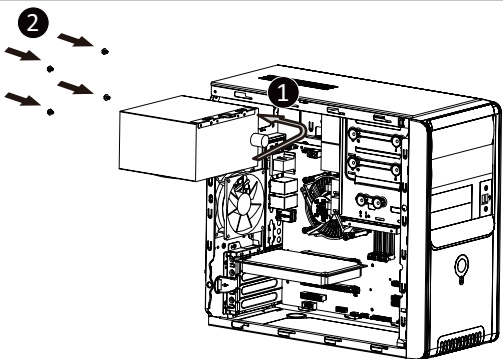

Hard Disk Drive

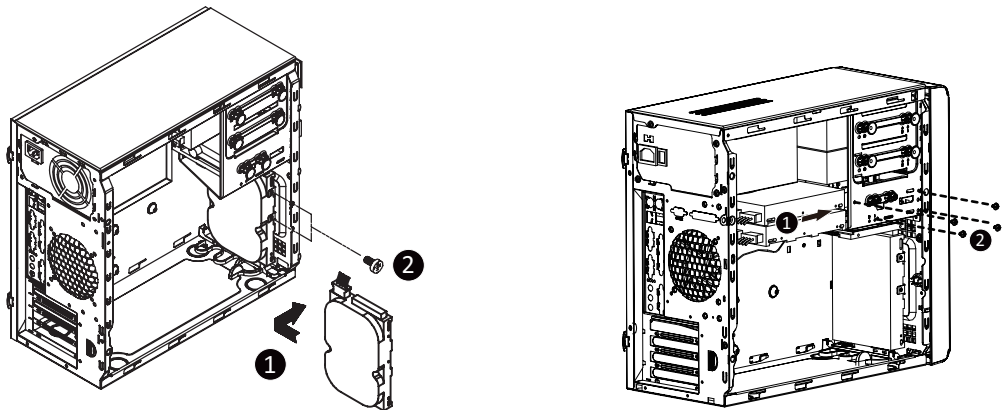

Regulatory Notices

WEEE Symbol Statement



The symbol shown below is on the product or on its packaging, which indicates that this product must not be disposed of with other waste. Instead, the device should be taken to the waste collection centers for activation of the treatment, collection, recycling and disposal procedure. The separate collection and recycling of your waste equipment at the time of disposal will help to conserve natural resources and ensure that it is recycled in a manner that protects human health and the environment. For more information about where you can drop off your waste equipment for recycling, please contact your local government office, your household waste disposal service or where you purchased the product for details of environmentally safe recycling.

- When your electrical or electronic equipment is no longer useful to you, "take it back" to your local or regional waste collection administration for recycling.
- If you need further assistance in recycling, reusing in your "end of life" product, you may contact us at the Customer Care number listed in your product's user's manual and we will be glad to help you with your effort.

Restriction of Hazardous Substances (RoHS) Directive Statement

GIGABYTE products have not intended to add and safe from hazardous substances (Cd, Pb, Hg, Cr+6, PBDE and PBB). The parts and components have been carefully selected to meet RoHS requirement. Moreover, we at GIGABYTE are continuing our efforts to develop products that do not use internationally banned toxic chemicals.

限制使用有害物质 (RoHS) 指令声明

GIGABYTE产品未故意添加和使用有害物质（Cd、Pb、Hg、Cr+6、PBDE和PBB）。所有部件和元件均经过严格挑选，符合RoHS要求。此外，我们GIGABYTE一直致力于开发不使用国际上禁止的有毒化学品的产品。

California Proposition 65 Warning

WARNING:
This product contains a chemicals , including lead, known to the State of California to cause cancer and birth defects or other reproductive harm. For more information, please visit: <http://www.p65warnings.ca.gov/>



Battery Warning:
Incorrectly installing a battery or using incompatible battery may increase the risk of ifre explosion. Replace the battery only with the same or equivalent type.

- Do not disassemble, crush, puncture batteries.
- Do not store or place your battery pack next to or in a heat source such as a fire, heatgenerating appliance, can or exhaust vent. Heating battery cells to temperatures above 65oC (149oF) can cause explosion or fire.
- Do not attempt to open or service batteries. Do not dispose of batteries in a fire or with household waste.



电池警告：
电池安装不当或使用不兼容的电池会增加火灾爆炸风险。更换电池时，只可使用相同或同等类型的电池。

- 请勿拆解、挤压、刺破电池。
- 请勿将电池存放或放置在热源中或旁边，如火源、产生热的设备、罐体或排气口。电池温度升至65oC (149oF)以上可能导致爆炸或火灾。
- 请勿尝试打开或维修电池。电池废弃时，请勿投入火中或者作为家庭废弃物进行处理。

中华人民共和国电子信息产品中有毒有害物质或元素的名称及含量标识格式

依照中华人民共和国的有毒有害物质的限制要求(China RoHS)提供以下的表格：



关于符合中国《电子信息产品污染控制管理办法》的声明
Management Methods on Control of Pollution from Electronic Information Products
(China RoHS Declaration)

产品中有毒有害物质或元素的名称及含量
Hazardous Substances Table

部件名称 (Parts)	有毒有害物质或元素 (Hazardous Substances)					
	铅 (Pb)	汞 (Hg)	镉 (Cd)	六价铬 (Cr (VI))	多溴联苯 (PBB)	多溴二苯醚 (PBDE)
PCB板 PCB	○	○	○	○	○	○
结构件及风扇 Mechanical parts and Fan	×	○	○	○	○	○
芯片及其他主动零件 Chip and other Active components	×	○	○	○	○	○
连接器 Connectors	×	○	○	○	○	○
被动电子元器件 Passive Components	×	○	○	○	○	○
线材 Cables	○	○	○	○	○	○
焊接金属 Soldering metal	○	○	○	○	○	○
助焊剂、散热膏、标签及其他耗材 Flux, Solder Paste, Label and other Consumable Materials	○	○	○	○	○	○
○:表示该有毒有害物质在该部件所有均质材料中的含量均在SJ/T11363-2006标准规定的限量要求以下。 Indicates that this hazardous substance contained in all homogenous materials of this part is below the limit requirement SJ/T 11363-2006						
×:表示该有毒有害物质至少在该部件的某一均质材料中的含量超出SJ/T11363-2006标准规定的限量要求。 Indicates that this hazardous substance contained in at least one of the homogenous materials of this part is above the limit requirement in SJ/T 11363-2006						
对销售之日所售产品，本表显示我公司供应链的电子信息产品可能包含这些物质。注意：在所售产品中可能会也可能不会含有所有列出的部件。 This table shows where these substances may be found in the supply chain of our electronic information products, as of the date of the sale of the enclosed products. Note that some of the component types listed above may or may not be a part of the enclosed product.						

Ambient Operation

This equipment should not be operated above an ambient operation temperature of 35 degrees centigrade.

Power Supply

CAUTION: The power supplies in your system may produce high voltages and energyhazards, which can cause bodily harms. Unless you are instructed otherwise, only trained service technicians are authorized to remove the covers and access any of the components inside the system.

Reliable Earthing:

CAUTION: Do not connect or disconnect any cables or perform installation, maintenance, or reconfiguration of this server during an electrical storm
CAUTION: Connect all power cords to a properly wired and grounded electrical outlet.

Hazardous FAN

CAUTION: This server contains hazardous moving fan blades, keep fingers and other bodyparts away.
Disconnect all power supply cords before servicing. Connect power supply cord only after all the covers are properly installed.

FCC Statement

This device complies with Part 15 of the FCC Rules.
Operation is subject to the following two conditions:
(1) This device may not cause harmful interference, and
(2) This device must accept any interference received, including interference that may cause undesired operation.

CAN ICES-3 (A)/NMB-3(A)

Connect With Us

For more information, visit our website at:

<http://b2b.gigabyte.com>

You are a professional?

Get access to our complete source of sales & marketing materials at:

<http://reseller.b2b.gigabyte.com>



<https://www.facebook.com/gigabyteserver>