

King Slide® — AP60-A17

1) Take out the inner member and slide the intermediate member back.

Screw Sack		
Item	NAME	
A	M5-NUT/2PCS	GG3C6020DI-ZZ0S
B	M5x10/8PCS	GJ3A0012DK-ZZ0S
C	Ø5.1Washer/8PCS	GG3A0009DF-ZZ0S
D	M4x6/6PCS	GJ3C0009DI-ZZ0S

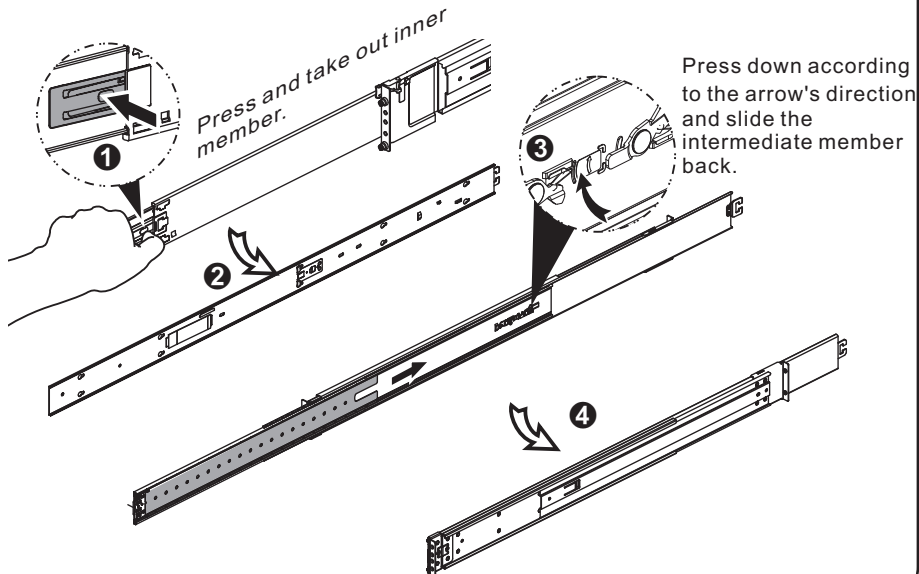

3) Attach the outer member/bracket to the rack.

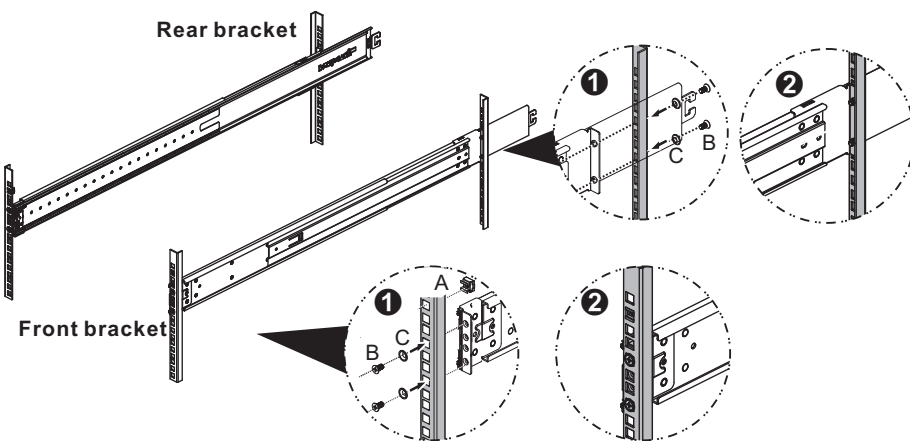

2) Install the inner member onto the chassis.

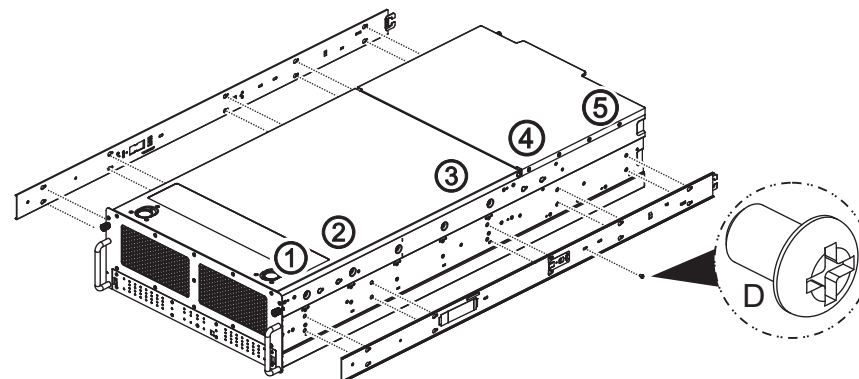

4) Insert the chassis to complete the installation.

Step 1.
Pull the middle member fully extended in lock position, ensure ball bearing retainer is located at the front of the middle member.

Step 2.
Insert chassis into middle-outer member. When hit a stop, pull / push release tab to retract chassis into rack.

