

King Slide® — AA612864

1) Take out the inner member and slide the intermediate member back.

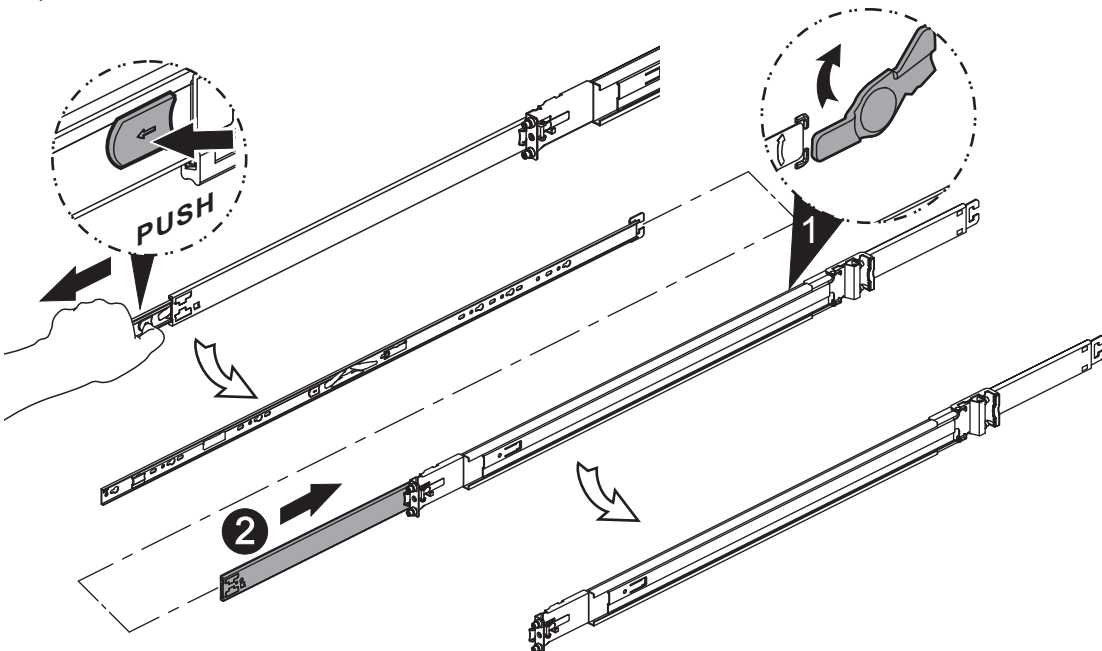

2) Install the inner member onto the chassis.

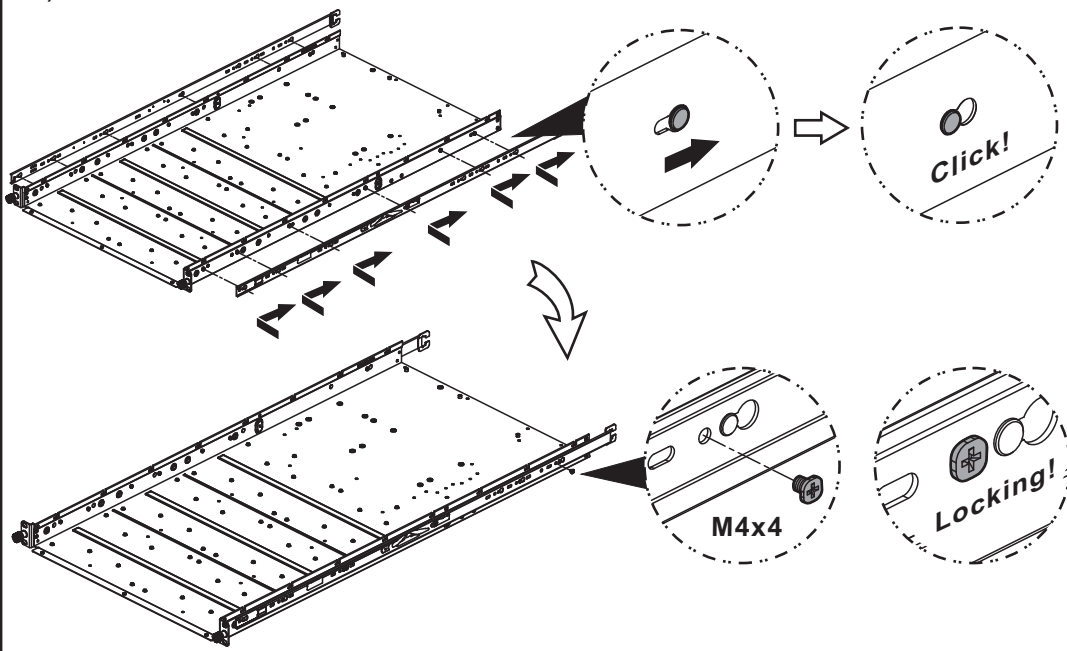

3. Fix the outer member/bracket assembly to the frame.

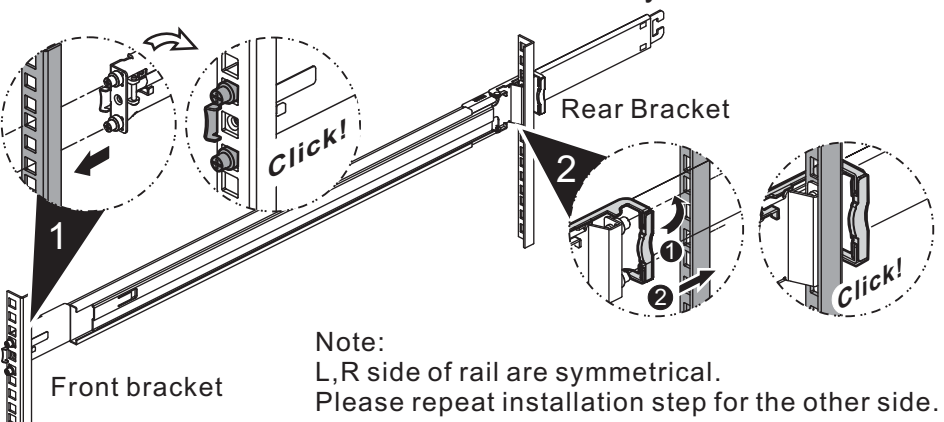

Removing bracket

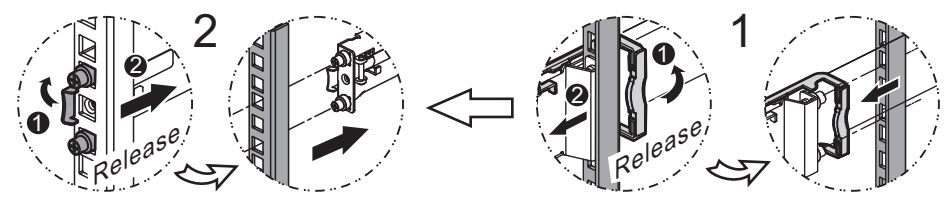

4. Insert the unit to complete the installation

Step 1.
Pull the middle member fully extended in lock position, ensure ball bearing retainer is located at the front of the middle member.

Step 2.
Insert chassis into middle-outer member. When hit a stop, pull / push release tab to retract chassis into rack.

Step 3.
Tighten the thumbscrew onto rack post to complete installation.

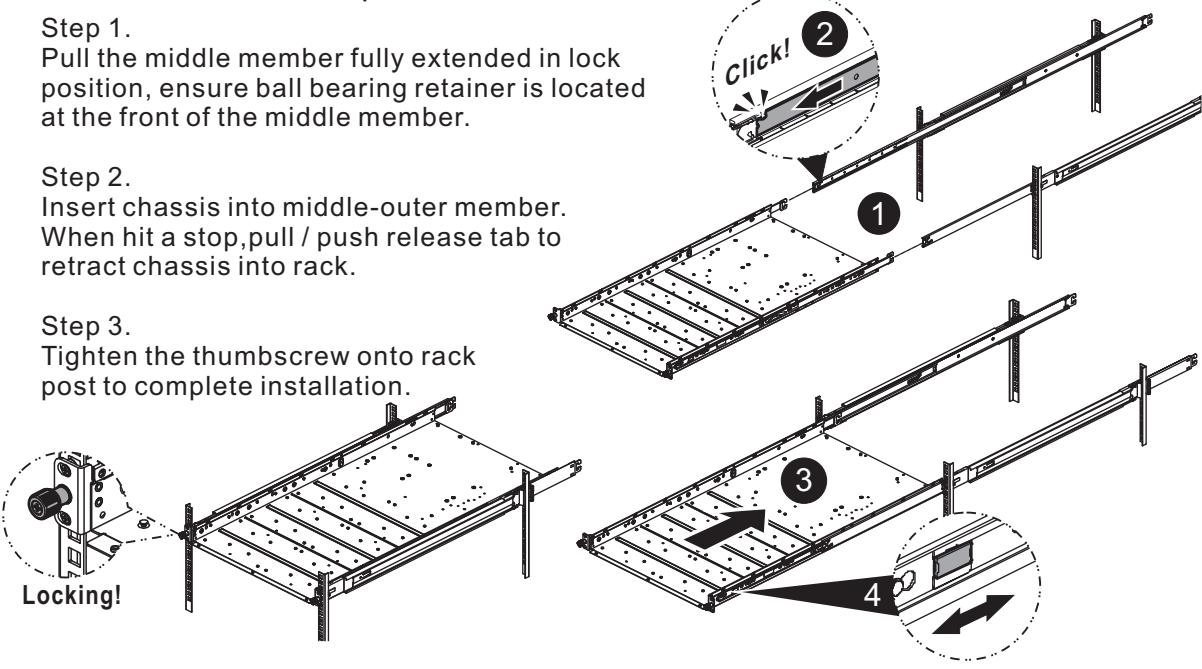

King Slide® — 2X*A7 (X*=2A/2B/2C/2D ; The drawings below are for assembling only. The real object should be considered as final.)

Before installation, check the Cable Management Arm (CMA) installation direction and switch the CMA connector.

1. Press "PUSH" button.
2. Spin 180 degree to change the direction.

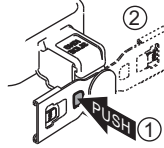

Basket size:

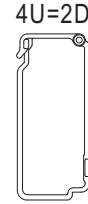
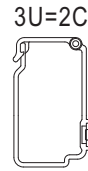
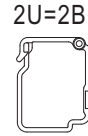
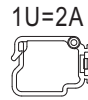

Cable Management Arm Installation

1. Install the inner member

Install (A) onto (B).

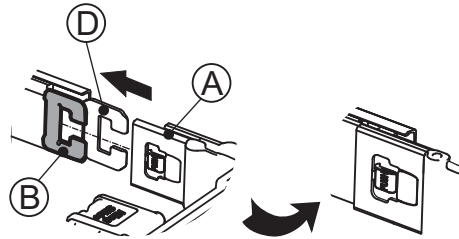

2. Install the outer member

Install (C) onto (D).

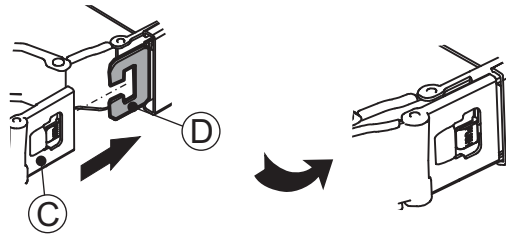

3. Install the outer member

Install (E) onto (F).

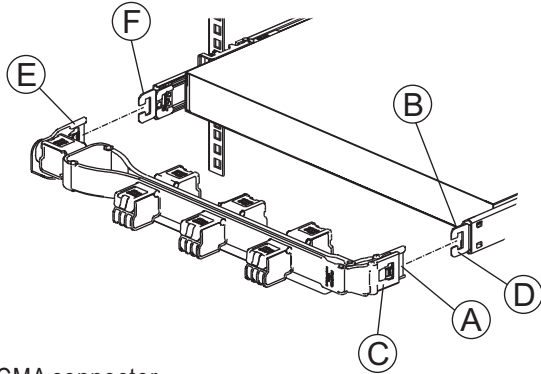
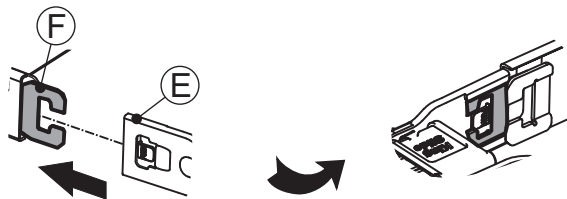

- A = CMA connector
- B = CMA connector base on inner member
- C = CMA connector
- D = CMA connector base on outer member
- E = CMA connector beside the center CMA body
- F = CMA connector base on outer member

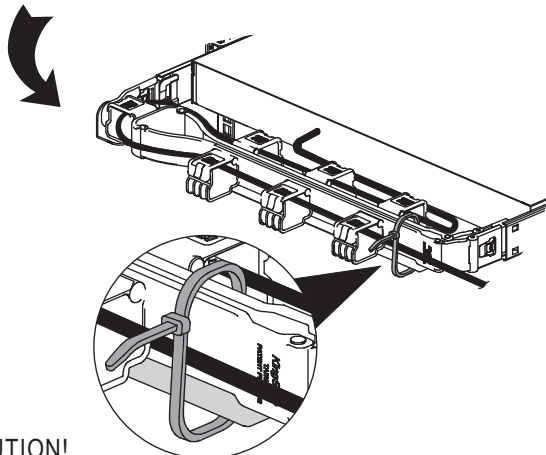

CAUTION!
Loop strap must be tied to the CMA crossbar. This is a transportation accessory; Remove the loop strap after the system arrives at the final destination.

Cable Management Arm Release

(1) Release the outer member

Press the "PUSH" button on the CMA plug-in part to draw it out.

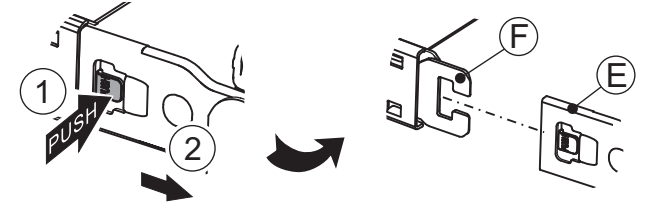

(2) Release the outer member

(A) Turn CMA 90 degree to the right hand side to maintain the chassis or resume the removal.
(B) Press the "PUSH" button on the CMA plug-in part to draw it out.

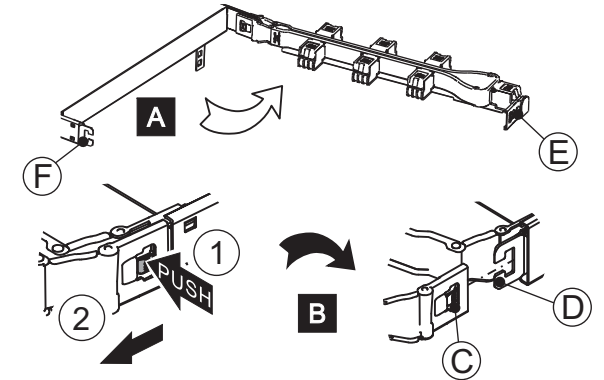

(3) Release the inner member

Press the "PUSH" button on the CMA plug-in part to draw it out.

